

Site Map

North Carolina
Monitoring Well Network
Glen Alpine Site, L 76G
Southwest of Morganton
Burke County, NC

NOTE: This map is for informational purposes only. It does not authorize any party to enter onto any lands depicted herein.

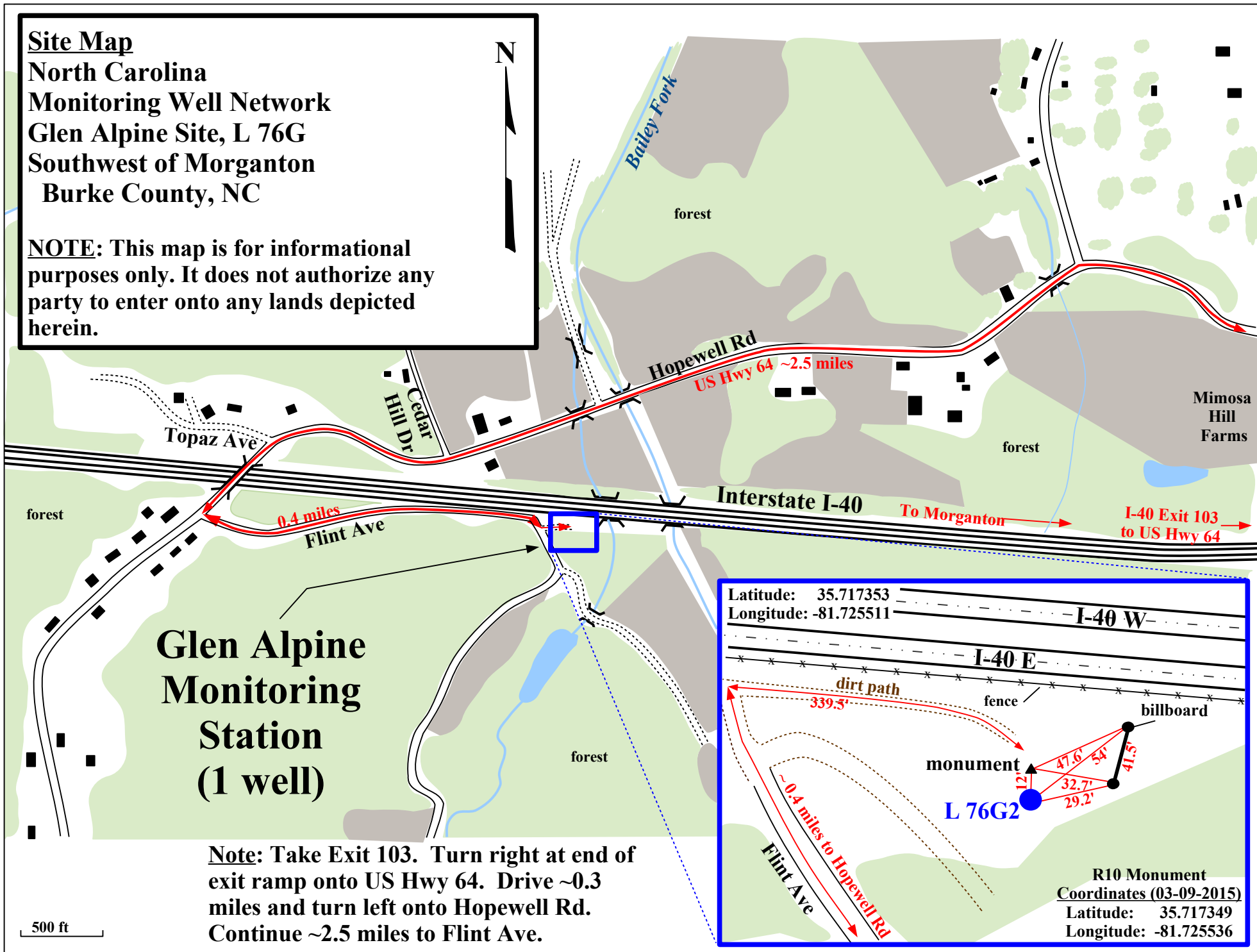

Glen Alpine Monitoring Station (1 well)

Note: Take Exit 103. Turn right at end of exit ramp onto US Hwy 64. Drive ~0.3 miles and turn left onto Hopewell Rd. Continue ~2.5 miles to Flint Ave.

Latitude: 35.717353
Longitude: -81.725511

I-40 W
I-40 E

dirt path
339.5'

fence

billboard

monument
L 76G2

47.6'
54'
41.5'
32.7'
29.2'

~0.4 miles to Hopewell Rd
Flint Ave

R10 Monument
Coordinates (03-09-2015)
Latitude: 35.717349
Longitude: -81.725536